



## P-SERIES

The Scania P – series Curtainsider has been designed to boost productivity for Australia's metropolitan and regional distribution operators.

In 310 hp guise, the P 310 8x2 delivers powerful, frugal, fuss-free five-cylinder 9.0-litre performance, backed by the latest and cleanest Euro 5 SCR technology. In 8x2 configuration it provides a strong and versatile basis for a variety of applications.

# P 310 8X2 TWIN STEER RIGID - READY BUILT Chassis Specification

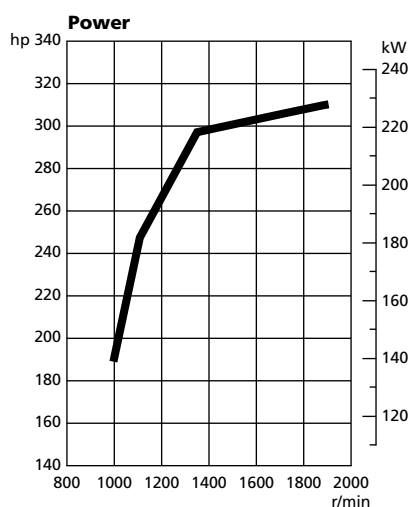

## Engine

- Scania DC9 310 9 Litre In-line 5 cylinder
- Power - 310hp (228kW) @ 1900rpm
- Torque - 1550Nm (1143lb/ft) @ 1100 - 1350rpm
- Euro5 (ADR 80/03)

## Engine Features

- Scania electronic fuel injection
- Single stage turbocharger
- SCR with catalytic convertor
- Centrifugal engine oil filter
- Spin-on turbo charger filter
- Cartridge style fuel filters

## Fan

- Eight blade, electronically controlled viscous drive

## Alternator

- Scania 24V, 100amp

## Compressor

- Knorr 720, twin cylinder, 800L/min with air dryer

## Air Cleaner

- Mounted under grille R/H side

## Gearbox

- Scania GRS895, Direct drive 12 speed

## Gearbox Features

- Scania Opticruise with Fully Automated Clutch
- PTO - Electrical Preparation

## Front & Rear Axles

### Front Axles

- Scania AMA 740

### Front Suspension

- Scania 4 bag air suspension
- 14200kg capacity with Anti Roll Bar

### Rear Axle - Driven

- Scania ADA 1303 Axle Housing
- R780 Differential
- Ratio 3.08 with Differential Lock

### Rear Axle - Lazy

- Scania ASA 1003

### Rear Suspension

- Scania 4 bag air suspension
- 19000kg capacity

### Brakes

- Scania electronically controlled disc brakes
- EBS with integrated ABS and Traction Control
- Hill hold

### Wheels

- Steel Disc, Silver painted
- 22.5" x 8.25" Tubeless rims
- 335mm PCD

### Tyres

- Front - Bridgestone 295/80 R22.5
- Rear - Bridgestone 295/80 R22.5

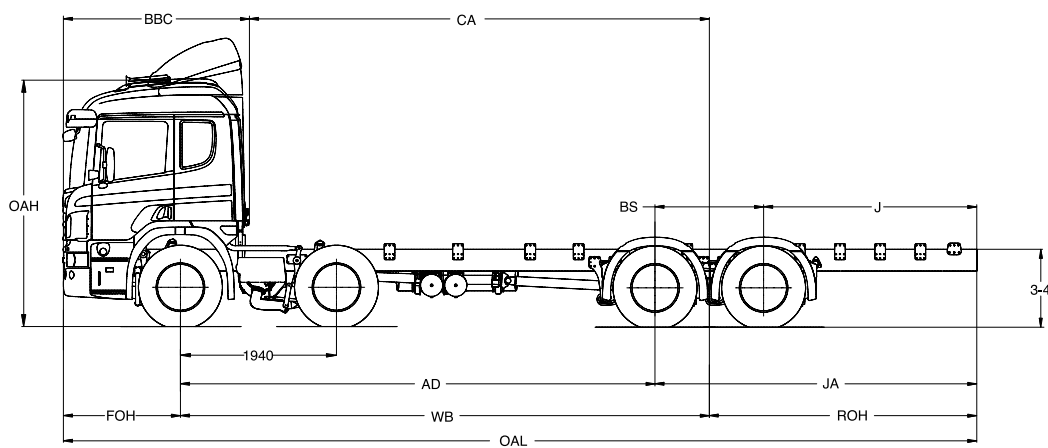

|     |        |     |           |
|-----|--------|-----|-----------|
| FOH | 1455mm | CA  | 5717mm    |
| AD  | 5900mm | 3-4 | 997-973mm |
| WB  | 6575mm | OAH | 3051mm    |
| BS  | 1350mm | OAL | 11355mm   |
| ROH | 3325mm | J   | 2650mm    |
| BBC | 2313mm | JA  | 4000mm    |

Tare Weight: Front = 6380kg,  
Rear = 3050kg, Total = 9430kg

Tare weight includes, tanks full of fuel.  
It does not include turntable, bull bar  
or driver.

Weight tolerance +/-5%

## Chassis

### Frame

- Scania F950, 270 x 90 x 9.5mm
- Width 770mm

### Paint

- Scania Sub-Grey (Powder Coat)

### Axle Distance

- 5900mm (6575mm wheelbase)
- Rear overhang 3325mm

### Fuel Tank

- Single 450L steel tank R/H side
- 1 x 50L Urea tank R/H

### Front Bumper

- High Mounted FUP compliant bumper
- FUP to ECE R93

### Batteries

- 2 x 180amp, 24V L/H side
- Chassis electrical connection for auxiliary equipment (Max 200amps)
- Scania Body Work System
- Cable Harness

## Cabin

- Scania CP19N sleeper cabin
- With four point spring suspension
- Cab Strength to ECE R29

### Paint

- Scania White
- With Grey Grille

### Exterior Equipment

- Aerodynamic main & spotter mirrors
- Electrically heated
- Electrically adjustable main mirror
- Close up mirror on passenger side
- Roof rails
- Roof mounted air horns
- Manual Central Locking
- Reverse alarm

### Lighting

- H7 headlights
- LED daytime running lights
- End outline marker - White LED
- Identification lamp - Amber LED
- Boarding step lights

### Safety

- Driver seat belt pretensioner
- Driver's air bag

### Interior Equipment

- Medium driver's seat
- Folding passenger seat
- Black woven trim
- Cruise Control & Dash display controlled from steering wheel
- Scania Colour dash display
- With rear axle load, hour meter, service information
- AM/FM radio, CD player, Bluetooth
- AUX MP3, input
- Phone electrical preparation.
- 12V outlet in dash
- FMS Preparation
- Resettable Circuit breakers
- Power Windows - Driver & Passenger
- Air conditioning
- Protective rubber floor mats
- UHF CB radio

## Additional Equipment

- 20m Tyre inflation hose
- Jack & wheel brace
- Globe Kit
- Drivers Manual
- Three safety triangles

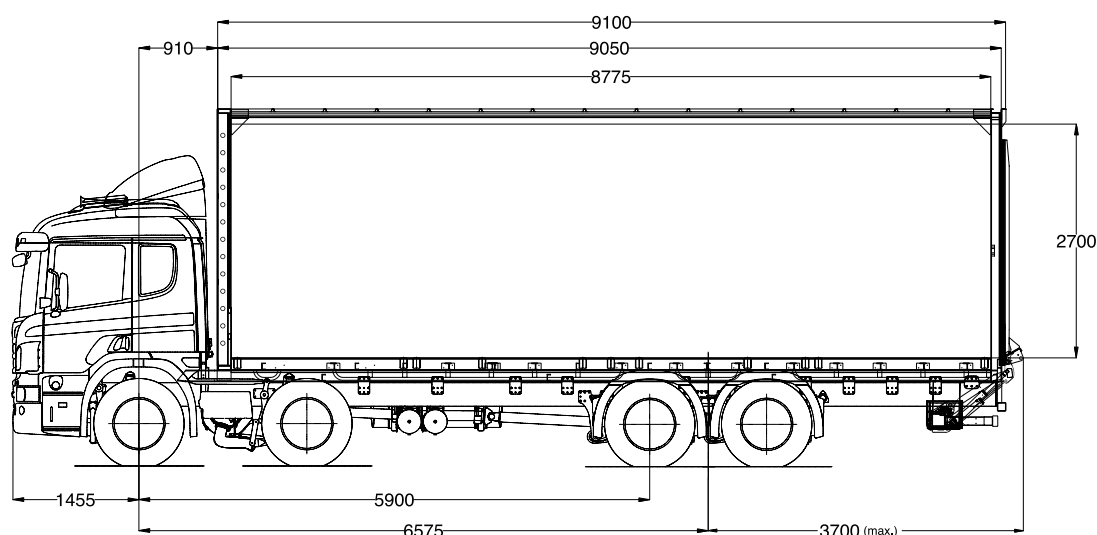

Tare Weight: Front = 6960, Rear = 5290, Total = 12250

Tare weight includes, tanks full of fuel. It does not include turntable, bull bar or driver.

Weight tolerance +/-5%

## 14 Pallet Curtain Rigid Body

### Dimensions

- Overall body length (BOL) = 9100 mm typical
- Side aperture height (BSAH) = 2700 mm typical
- Rear door aperture height (BRAH) = 2767 mm typical
- Vehicle overall height (OAH) = 4119 mm typical
- Loading floor height (BFH) = 1260 mm typical

Optional body heights can be produced

### Construction

- Composite chequer plate pattern floor
- Coaming rails with gate pockets & rope rails
- Curtain tensioners front & rear
- Rear bumper

### Lighting

- Multi voltage LED side marker lights

### Finish

- White curtains and body

### Options

- Toolbox or multiple boxes
- Ratchet winch load restraint webbing assembly
- Ratchet winch guide and storage track
- Gates
- Access step ladder
- Tail lift
- Load restraint compliant curtains



**SCANIA**  
Total Transport Solutions  
scania.com.au

#### Head Office

212 – 216 Northbourne Rd  
Campbellfield, 3061  
Tel: (03) 9217 3300

#### Scania VIC

(Campbellfield)  
212 – 216 Northbourne Rd  
Campbellfield, 3061  
Tel: (03) 9217 3300

#### Scania VIC

(Dandenong)  
2/66 Greens Rd  
Dandenong South, 3175  
Tel: (03) 9217 3600

#### Scania VIC

(Laverton)  
125 – 129 Boundary Rd  
Laverton, 3026  
Tel: (03) 9369 8666

#### Scania NSW

(Prestons)  
16 – 18 Lyn Pde  
Prestons, 2170  
Tel: (02) 9825 7900

#### Scania NSW

(Newcastle)  
1 Enterprise Drive  
Beresfield, 2322  
Tel: (02) 9825 7940

#### K&J Trucks NSW

Lot 1 A1  
Coffs Harbour, 2450  
Tel: (02) 6652 7218

#### NJ's of Wagga NSW

301 Copland Street  
Wagga Wagga, 2650  
Tel: (02) 6971 7214

#### Scania QLD

(Richlands)  
149 Archerfield Rd  
Richlands, 4077  
Tel: (07) 3712 8500

#### Scania QLD

(Pinkenba)  
213 Holt St  
Pinkenba, 4008  
Tel: (07) 3712 7900

#### RSC Diesels

(Cairns)  
29-31 Ponzo St  
Woree, 4868  
Tel: (07) 4054 5440

#### Scania SA

(Wingfield)  
218 – 234 Cormack Rd  
Wingfield, 5010  
Tel: (08) 8406 0200

#### Scania WA

(Kewdale)  
527 – 529 Abernethy Rd  
Kewdale, 6105  
Tel: (08) 9360 8500

#### Scania WA

(Bunbury)  
12 Proffitt St  
Davenport, 6230  
Tel: (08) 9724 6200