



# P 340 6X2 RIGID

CNG CHASSIS SPECIFICATION



**SCANIA**

# P 340 6X2 RIGID

## CNG CHASSIS SPECIFICATION

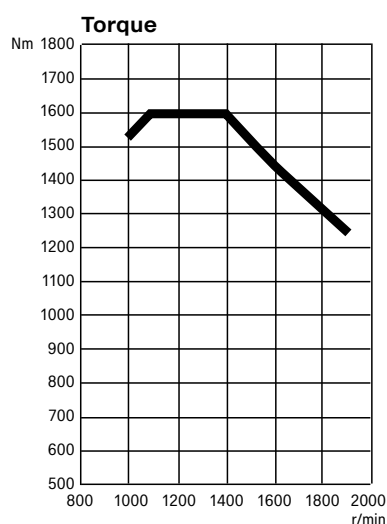
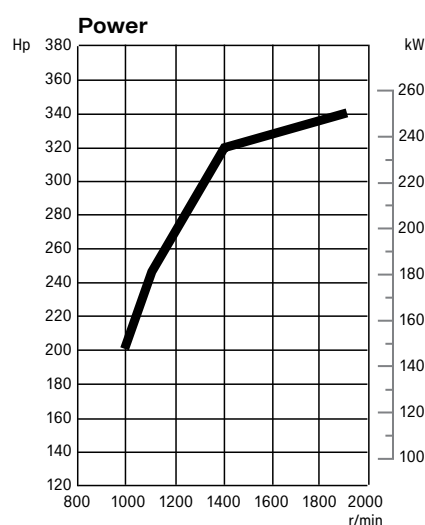

### ENGINE

- Scania DC09 340 9.0 Litre In-line 5 cylinder
- Power – 340 hp (254 kW) @1900 rpm
- Torque – 1600 Nm (1180 lb-ft) @1100 - 1400 rpm
- Euro6 (ADR 80/03)

### ENGINE FEATURES

- Otto principal engine
- Spark plugs and separate ignition coils for each cylinder
- Four valves per cylinder
- Turbocharger and charge air cooler

#### FAN

- Electronically controlled viscous drive

#### ALTERNATOR

- Scania 24 V, 100 amp

#### COMPRESSOR

- Knorr 720, twin cylinder, 800 L/min with air drier

#### AIR CLEANER

- Mounted under the grille RH side

### GEARBOX

- Scania GRS895R, Direct 12 speed
- With Scania Retarder

### GEARBOX FEATURES

- Scania Opticruise with Fully Automated Clutch
- PTO – Electrical Preparation
- R3500 Retarder

### FRONT & REAR AXLES

#### FRONT AXLES

- Scania AM660S

#### FRONT SUSPENSION

- 2 x 33 parabolic front springs 7500 kg capacity with anti roll bar

#### REAR AXLES

- Scania AD400SA Axle housings
- Scania A600SA (tag axle)
- Scania RB662/R660 Differentials
- Ratio 3.08 with differential locks

#### REAR SUSPENSION

- Scania 4 bag air suspension (19,000 kg capacity)

#### BRAKES

- Scania electronically controlled disc brakes
- EBS with integrated ABS and

#### TRACTION CONTROL

- Hill hold

#### WHEELS

- Alcoa DuraBright
- 22.5" x 8.25" Tubeless rims
- 335 mm PCD

#### TYRES

- Front – Bridgestone 295/80R22.5
- Rear – Bridgestone 295/80R22.5

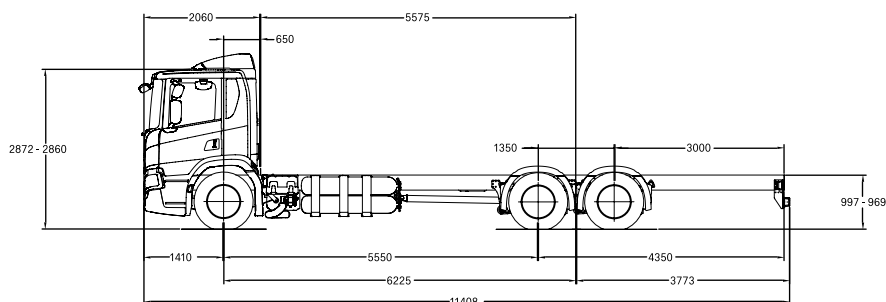

Turntable mounting angles protrude 40 mm above the chassis.

Tare Weight: Front = 5652 kg, Rear = 3657 kg, Total = 9309 kg

Tare Weight includes tanks full of fuel. It does not include bullbar or driver.

Weight Tolerance +/- 5%

## CHASSIS

### FRAME

- Scania F950 (270 x 90 x 9.5) mm
- Width 770mm

### PAINT

- Scania Sub-Grey (Powder Coat) Fuel Tanks & Urea
- 4 x 118 dm3 (RH)

### BATTERIES

- 24 V (2x12 V, 180 Ah) LH Side
- Chassis electrical connection for auxiliary equipment

### TRAILER CONNECTIONS - BRAKES

- Trailer Supply & Emergency to Rear of Chassis

### TRAILER CONNECTIONS - ELECTRICAL

- 24 V trailer light outlet (ISO 1185)
- 24 V trailer 7-pin ABS outlet
- Scania Body Work System with

### CABLE HARNESS

- Front Mudguards with Spray suppression

## CABIN

- Scania CP17 Low with four point spring suspension
- Cab Strength to ECE R29

### PAINT

- Cabin painted Scania white
- With Grey grille

### MIRRORS

- Aerodynamic main & spotter mirrors electrically heated
- Electrically adjustable main mirrors
- Close up mirror on passenger side
- Front view mirror - Electrically heated

### EXTERIOR EQUIPMENT

- Roof rails with full air deflector kit
- Roof mounted air horns
- Manual roof hatch with mosquito net
- Remote Central Locking
- Reverse alarm

### LIGHTING

- H7 headlights
- End outline marker – White LED
- Identification lamp – White LED
- Boarding step lights

### SAFETY

- Driver and passenger seat belt pretensioner
- Driver and passenger side curtain air bag
- Electronic stabiliser program (ESP)
- Lane departure warning (LDW)
- Advanced emergency braking (AEB)
- Adaptive cruise control (ACC)

## INTERIOR EQUIPMENT

- Medium driver's seat with armrest
- Medium passenger seat
- Woven trim
- Cruise Control & Dash display controlled from the steering wheel
- Scania 7" colour dash display featuring rear axle load, hour meter, service and vehicle information
- Premium 7" Infotainment system
- Phone electrical preparation
- 12 V outlet in dash
- FMS Preparation
- Resettable circuit breakers
- Power windows
- Manual climate control with air conditioning
- Curtains, windscreen & doors
- Protective rubber floor mats
- UHF CB Radio

## ADDITIONAL EQUIPMENT

- 20 m tyre inflation hose
- Jack & wheel brace
- Globe kit
- Driver's manual
- Three safety triangles

For more information contact your  
Scania branch or local dealer.

#### **HEAD OFFICE**

212 – 216 Northbourne Rd  
Campbellfield, 3061  
Tel: (03) 9217 3300

#### **VICTORIA**

##### **Scania Campbellfield**

212 – 216 Northbourne Rd  
Campbellfield, 3061  
Tel: (03) 9217 3300

##### **Scania Dandenong**

2/66 Greens Rd  
Dandenong South, 3175  
Tel: (03) 9217 3600

##### **Scania Laverton**

125 – 129 Boundary Rd  
Laverton, 3026  
Tel: (03) 9369 8666

#### **NEW SOUTH WALES**

##### **Scania Prestons**

16 – 18 Lyn Pde  
Prestons, 2170  
Tel: (02) 9825 7900

##### **Midcoast Trucks**

Lot 1 Pacific Highway  
Boambee, 2450  
Tel: (02) 6652 7218

#### **QUEENSLAND**

##### **Scania Richlands**

149 Archerfield Rd  
Richlands, 4077  
Tel: (07) 3712 8500

##### **Scania Pinkenba**

213 Holt St  
Pinkenba, 4008  
Tel: (07) 3712 7900

#### **SOUTH AUSTRALIA**

##### **Scania Wingfield**

218 – 234 Cormack Rd  
Wingfield, 5010  
Tel: (08) 8406 0200

#### **WESTERN AUSTRALIA**

##### **Scania Kewdale**

527 – 529 Abernethy Rd  
Kewdale, 6105  
Tel: (08) 9360 8500

IMPORTANT. The specifications in this brochure were correct at the time of printing.  
All weights and measurements are approximate only. Images in this brochure may  
display some features not included in the standard specification. Scania Australia  
reserves the right to change specifications without prior notice.

