



# G 500 XT 6X4 RIGID

## CHASSIS SPECIFICATION



**SCANIA**

# G 500 XT 6X4 RIGID

## CHASSIS SPECIFICATION

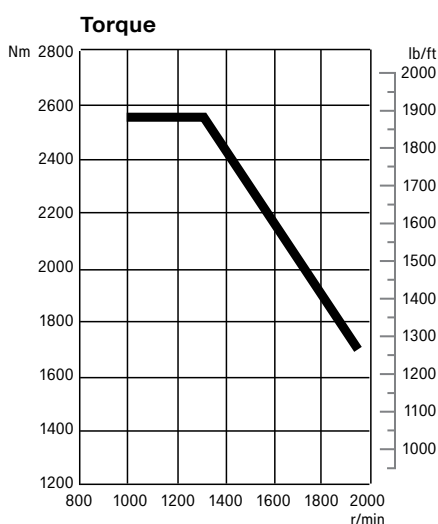
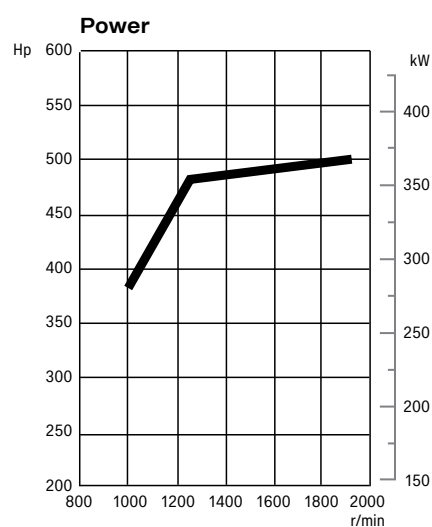

### ENGINE

- Scania DC 13 500 12.7 Litre In-line 6 cylinder engine
- Power - 500hp (373kW) @1900rpm
- Torque - 2550Nm (1881ft/lb) @1000 - 1300rpm
- EURO 6

### ENGINE FEATURES

- Scania electronic fuel injection
- Single stage turbocharger
- SCR with catalytic converter
- Centrifugal engine oil filter
- Spin-on turbocharger oil filter
- Cartridge style fuel filters

### FAN

- Electronically controlled viscous drive

### ALTERNATOR

- Scania 24V, 100amp

### COMPRESSOR

- Knorr 720, twin cylinder, 800L/min with air drier

### AIR CLEANER

- Mounted under the grille R/H side

### GEARBOX

- Scania GRS0905R, Overdrive 14 speed
- Retarder R3500

### GEARBOX FEATURES

- Scania Opticruise with fully automatic clutch
- Gearbox oil cooler
- PTO EG rear

### FRONT & REAR AXLES

#### FRONT AXLE

- Scania AM 600S

#### FRONT SUSPENSION

- 2 x 32 parabolic front springs 7100kg capacity with anti roll bar

#### REAR AXLES

- Scania AD400SA Axle housings
- Scania RB662/R660 Differentials
- Ratio 3.42 with power divider and differential locks

#### REAR SUSPENSION

- Scania 4 bag air suspension (19000kg capacity)

#### BRAKES

- Scania electronically controlled disc brakes
- EBS with integrated ABS and Traction Control
- Hill hold

#### WHEELS

- Aluminium Durabright
- 22.5" x 8.25" Tubeless rims
- 335mm PCD

#### TYRES

- Front - 295/80 R22.5 R S BR
- Rear - 295/80 R22.5 R D BR

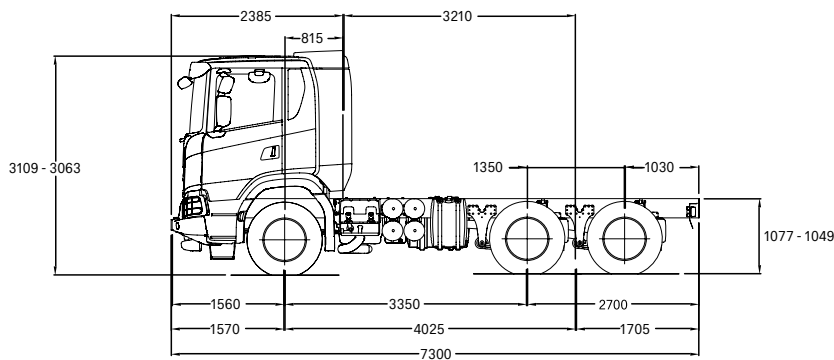

Tare Weight: Front = 5537kg, Rear = 3376kg,  
Total = 8913kg.

Tare weight includes, tanks full of fuel.  
It does not include driver.

Tare weight may vary +/- 5% depending  
on vehicle specifications.

\* Depend on chassis height and tyre size.

## CHASSIS

### FRAME

- Scania F950, 270 x 90 x 9.5mm
- Width 770mm

### PAINT

- Scania Sub-Grey (Powder Coat)

### AXLE DISTANCE

- 3350mm (4025mm wheel base)
- Rear overhang JA 2700mm

### FUEL & UREA TANKS

- 550L (1x200L L/H, 1x350L R/H)
- 1 x 80L Urea tank R/H

### FRONT BUMPER

- High Mounted FUP compliant bumper
- FUP to ECE R93

### BATTERIES

- 24V (2x12V, 180amp) L/H Side
- Chassis electrical connection for auxiliary equipment

### TRAILER CONNECTIONS - BRAKES

- To the rear of the chassis

### TRAILER CONNECTIONS - ELECTRICAL

- 24V trailer light outlets (ISO 1185)
- 24V trailer 7pin ABS outlet
- Scania Body Work System with Cable Harness

## CABIN

- Scania CG17 Low Cab with four point spring suspension
- Cab Strength to ECE R29
- Cabin painted Ivory White
- With Black Charcoal grille mirrors
- Aerodynamic main & spotter mirrors electrically heated
- Electrically adjustable mirrors
- Close up mirror on passenger side
- Front view mirror electrically heated

### EXTERIOR EQUIPMENT

- Roof rails with full air deflector kit
- Roof mounted air horns
- Central locking
- Reverse alarm

### LIGHTING

- H7 headlights
- LED daytime running lights
- End outline marker - White LED
- Identification lamp - White LED
- Boarding step lights
- Spot light front grille

### SAFETY

- Driver seat belt pretensioner
- Driver's steering wheel air bag
- Lane departure warning (LDW)
- Advanced emergency braking (AEB)
- Adaptive cruise control (ACC)
- Electronic stabiliser program (ESP)
- Driver and passenger side curtain airbag

## INTERIOR EQUIPMENT

- Medium A driver's seat, woven XT with armrests
- Medium A passenger seat
- Woven trim
- Cruise control and dash display controlled from the steering wheel
- Scania 7 inch colour dash display featuring rear axle load, hour meter, service and vehicle information
- Premium 7 inch infotainment system
- AUX MP3, input
- Phone electrical preparation
- 12V USB in dash
- FMS Preparation
- Resettable circuit breakers
- Power windows
- Manual climate control with air conditioning
- Curtains, windscreen & doors
- Protective rubber floor mats
- UHF CB radio

## ADDITIONAL EQUIPMENT

- 20m tyre inflation hose
- Jack & wheel brace
- Globe kit
- Drivers manual
- Three safety triangles

For more information contact your  
Scania branch or local dealer.

#### **HEAD OFFICE**

212 – 216 Northbourne Rd  
Campbellfield, 3061  
Tel: (03) 9217 3300

#### **VICTORIA**

##### **Scania Campbellfield**

212 – 216 Northbourne Rd  
Campbellfield, 3061  
Tel: (03) 9217 3300

##### **Scania Dandenong**

2/66 Greens Rd  
Dandenong South, 3175  
Tel: (03) 9217 3600

##### **Scania Laverton**

125 – 129 Boundary Rd  
Laverton, 3026  
Tel: (03) 9369 8666

#### **NEW SOUTH WALES**

##### **Scania Prestons**

16 – 18 Lyn Pde  
Prestons, 2170  
Tel: (02) 9825 7900

##### **Midcoast Trucks**

Lot 1 Pacific Highway  
Boambee, 2450  
Tel: (02) 6652 7218

#### **QUEENSLAND**

##### **Scania Richlands**

149 Archerfield Rd  
Richlands, 4077  
Tel: (07) 3712 8500

##### **Scania Pinkenba**

213 Holt St  
Pinkenba, 4008  
Tel: (07) 3712 7900

#### **SOUTH AUSTRALIA**

##### **Scania Wingfield**

218 – 234 Cormack Rd  
Wingfield, 5010  
Tel: (08) 8406 0200

#### **WESTERN AUSTRALIA**

##### **Scania Kewdale**

527 – 529 Abernethy Rd  
Kewdale, 6105  
Tel: (08) 9360 8500

IMPORTANT. The specifications in this brochure were correct at the time of printing.  
All weights and measurements are approximate only. Images in this brochure may  
display some features not included in the standard specification. Scania Australia  
reserves the right to change specifications without prior notice.



# **SCANIA**